

OFF-SHORE CONTAINERS

- Material: S355J2H and S235JRH
- Design temperature: -20° +50°
- Certification Body: RINA International S.r.l.



Basket e Containers certificati secondo le norme:
Baskets and Containers certified according to:

EN 12079-1 /2006 - DNV 2.7.1

BASKET 1650



External size (mm)	L1650 * W1650 * H1630
Internal Size (mm)	L1450 * W1500 * H1340
MGW	6100 Kg
TARE	1100 Kg
PAYLOAD	5000 Kg
Certificate num.	IM / 2012 / 00122

SLING DECLARATION OF CONFORMITY IN ACCORDING TO EN 13414 – EN 12079
0° - 60° WORK LOAD LIMIT: KN 92,16 SAFETY FACTOR: 5:1
0° - 90° WORK LOAD LIMIT: KN 80,08

BASKET 1800



External size (mm)	L1800 * W1200 * H1605
Internal Size (mm)	L1680 * W1080 * H1430
MGW	2400 Kg
TARE	400 Kg
PAYLOAD	2000 Kg
Certificate num.	IM / 2012 / 00353

SLING DECLARATION OF CONFORMITY IN ACCORDING TO EN 13414 – EN 12079
0° - 90° WORK LOAD LIMIT: KN 31,18 SAFETY FACTOR: 5:1

BASKET 2000



External size (mm)	L2000 * W600 * H850
Internal Size (mm)	L1800 * W400 * H560
MGW	5470 Kg
TARE	470 Kg
PAYLOAD	5000 Kg
Certificate num.	10-932-17403-D - 1

SLING DECLARATION OF CONFORMITY IN ACCORDING TO EN 13414 – EN 12079
0° - 90° WORK LOAD LIMIT: KN 72,53 SAFETY FACTOR: 5:1

BASKET 2200



External size (mm)	L2200 * W1200 * H1285
Internal Size (mm)	L2000 * W1000 * H1002
MGW	5650 Kg
TARE	650 Kg
PAYLOAD	5000 Kg
Certificate num.	IM / 2012 / 00369

SLING DECLARATION OF CONFORMITY IN ACCORDING TO EN 13414 – EN 12079
0° - 90° WORK LOAD LIMIT: KN 105,68 SAFETY FACTOR: 5:1

BASKET 3000

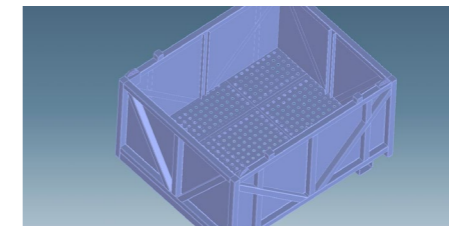

External size (mm)	L3000 * W600 * H850
Internal Size (mm)	L2800 * W400 * H560
MGW	5630 Kg
TARE	630 Kg
PAYLOAD	5000 Kg
Certificate num.	IM / 2012 / 00369

SLING DECLARATION OF CONFORMITY IN ACCORDING TO EN 13414 – EN 12079
0° - 90° WORK LOAD LIMIT: KN 105,68 SAFETY FACTOR: 5:1

BASKET 3120



External size (mm)	L3120 * W2250 * H1613
Internal Size (mm)	L2920 * W2130 * H1343
MGW	11500 Kg
TARE	1500 Kg
PAYLOAD	10000 Kg
Certificate num.	IM / 2012 / 00123

SLING DECLARATION OF CONFORMITY IN ACCORDING TO EN 13414 – EN 12079
0° - 60° WORK LOAD LIMIT: KN 144,38 SAFETY FACTOR: 5:1
0° - 90° WORK LOAD LIMIT: KN 117,94

BASKET 4000



External size (mm)	L4000 * W1000 * H1000
Internal Size (mm)	L3800 * W800 * H720
MGW	
TARE	1100 Kg
PAYLOAD	10.000 Kg
Certificate num.	

SLING DECLARATION OF CONFORMITY IN ACCORDING TO EN 13414 – EN 12079

BASKET 6000



External size (mm)	L6000 * W1000 * H1000
Internal Size (mm)	L5800 * W800 * H850
MGW	6430 Kg
TARE	1430 Kg
PAYLOAD	5000 Kg
Certificate num.	10-32-17403-b

SLING DECLARATION OF CONFORMITY IN ACCORDING TO EN 13414 – EN 12079
0° - 60° WORK LOAD LIMIT: KN 92,16 SAFETY FACTOR: 5:1
0° - 90° WORK LOAD LIMIT: KN 80,08

BASKET 6200



External size (mm)	L6200 * W1400 * H1285
Internal Size (mm)	L6000 * W1200 * H1002
MGW	6400 Kg
TARE	1400 Kg
PAYLOAD	5000 Kg
Certificate num.	IM / 2012 / 00370

SLING DECLARATION OF CONFORMITY IN ACCORDING TO EN 13414 – EN 12079
0° - 90° WORK LOAD LIMIT: KN 105,68 SAFETY FACTOR: 5:1

BASKET 7000



External size (mm)	L7000 * W1000 * H1000
Internal Size (mm)	L6800 * W800 * H850
MGW	6600 Kg
TARE	1600 Kg
PAYLOAD	5000 Kg
Certificate num.	10-32-17403-E

SLING DECLARATION OF CONFORMITY IN ACCORDING TO EN 13414 – EN 12079
0° - 90° WORK LOAD LIMIT: KN 139,22 SAFETY FACTOR: 5:1

BASKET 11900



External size (mm)	L11900 * W1200 * H1000
Internal Size (mm)	L11700 * W1000 * H850
MGW	12650 Kg
TARE	2650 Kg
PAYLOAD	10000 Kg
Certificate num.	10-32-17403-A/A1

SLING DECLARATION OF CONFORMITY IN ACCORDING TO EN 13414 – EN 12079
0° - 90° WORK LOAD LIMIT: KN 139,22 SAFETY FACTOR: 5:1

BASKET 19300



External size (mm)	L19300 * W1200 * H1000
Internal Size (mm)	L19100 * W900 * H660
MGW	14800 Kg
TARE	4800 Kg
PAYLOAD	10000 Kg
Certificate num.	IM / 2012 / 00178

SLING DECLARATION OF CONFORMITY IN ACCORDING TO EN 13414 – EN 12079
0° - 60° WORK LOAD LIMIT: KN 198,53 SAFETY FACTOR: 5:1
0° - 90° WORK LOAD LIMIT: KN 162,16

BASKET PER FUSTI

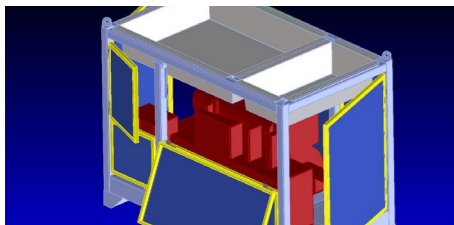

External size (mm)	L3400 * W2460 * H1810
MGW / TARE / PAYLOAD	7000 Kg / 2000 Kg / 5000 Kg
Certificate num.	IM / 2013 / 0030 / 1

SLING 0° - 90° WORK LOAD LIMIT: KN 130,39 SAFETY FACTOR: 5:1

BOX 2050



External size (mm)	L2151 * W1051 * H898
MGW / TARE / PAYLOAD	950 Kg / 450 Kg / 500 Kg
Certificate num.	IM / 2012 / 00305

SLING 0° - 90° WORK LOAD LIMIT: KN 31,18 SAFETY FACTOR: 5:1

2340 ENGINE



External size (mm)	L2340 * W1350 * H1845
MGW	3000 Kg
TARE	2600 Kg
PAYLOAD	400 Kg
Certificate num.	10-932-17403-F

2340/1 ENGINE



External size (mm)	L2340 * W1350 * H1845
MGW	6500 Kg
TARE	1500 Kg
PAYLOAD	5000 Kg
Certificate num.	IM / 2012 / 00077

2300 ENGINE



External size (mm)	L2300 * W1310 * H1630
MGW	1900 Kg
TARE	900 Kg
PAYLOAD	1000 Kg
Certificate num.	IM / 2012 / 00447

2460 ENGINE



External size (mm)	L3400 * W2460 * H1810
MGW	7000 Kg
TARE	5000 Kg
PAYLOAD	2000 Kg
Certificate num.	IM / 2012 / 00483